

JIS SWING CHECK VALVE 15A-100 H44W-10K

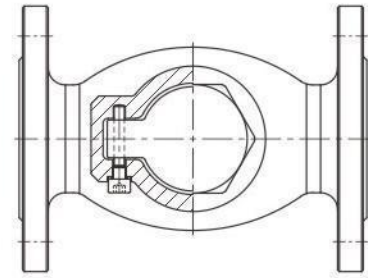
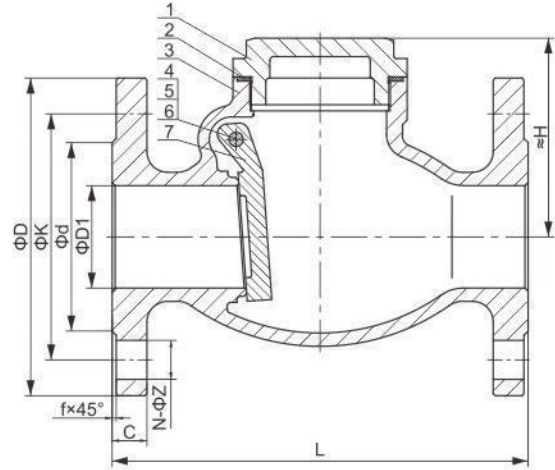

技术要求 Applicable Standards

1. 设计标准 Design Rating: JIS B2071, ASME B 16.34;
2. 结构长度 Face to Face: JIS B2002;
3. 法兰标准 Flanged Ends: JIS B2220;
4. 检查和试验 Inspection & Testing: JIS B2003.

主要零部件材料 Main Parts and Materials

| No. | 零件名称 PAPT NAME | 材质 MATERIAL |
|-----|----------------|-------------|
| 1 | 阀盖 Bonnet | SCS13/SCS14 |
| 2 | 密封垫 Gasket | PTFE |
| 3 | 阀体 Body | SCS13/SCS14 |
| 4 | 螺钉 Screw | 304 |

| No. | 零件名称 PAPT NAME | 材质 MATERIAL |
|-----|---------------------|-------------|
| 5 | 圆柱销 Cylindrical pin | 304 |
| 6 | 密封垫 Gasket | PTFE |
| 7 | 阀瓣 Disc | SCS13/SCS14 |
| 8 | | |

Note: This diagram expressing only component material details and dimensions; Other shipment please prevail in kind!!!

主要外形尺寸和连接尺寸 Main External and Connecting Dimensions

| DN | D1 | d | K | D | f | C | N-ΦZ | L | H |
|------|-----|-----|-----|-----|---|----|------|-----|-----|
| 15A | 15 | 51 | 70 | 95 | 1 | 12 | 4-15 | 108 | 56 |
| 20A | 20 | 56 | 75 | 100 | 1 | 14 | 4-15 | 117 | 62 |
| 25A | 25 | 67 | 90 | 125 | 1 | 14 | 4-19 | 127 | 66 |
| 32A | 32 | 76 | 100 | 135 | 2 | 16 | 4-19 | 140 | 68 |
| 40A | 40 | 81 | 105 | 140 | 2 | 16 | 4-19 | 165 | 77 |
| 50A | 50 | 96 | 120 | 155 | 2 | 16 | 4-19 | 203 | 97 |
| 65A | 65 | 116 | 140 | 175 | 2 | 18 | 4-19 | 216 | 113 |
| 80A | 80 | 126 | 150 | 185 | 2 | 18 | 8-19 | 241 | 124 |
| 100A | 100 | 151 | 175 | 210 | 2 | 18 | 8-19 | 292 | 148 |

JIS SWING CHECK VALVE 50A-500A H44H-10K

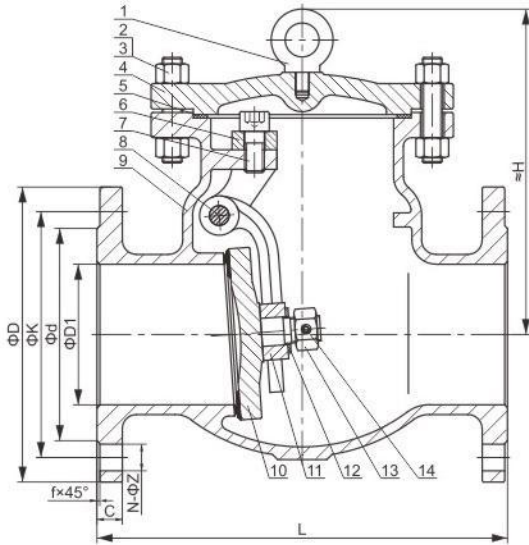

技术要求 Applicable Standards

1. 设计标准 Design Rating: KSB2361, JIS B2071, ASME B 16.34;
2. 结构长度 Face to Face: KSB2361, JIS B2002;
3. 法兰标准 Flanged Ends: KSB2361, JIS B2220;
4. 检查和试验 Inspection & Testing: KSB2361, JIS B2003.

主要零部件材料 Main Parts and Materials

| No. | 零件名称 PAPT NAME | 材质 MATERIAL | |
|-----|--------------------|--------------|-------------|
| 1 | 吊环螺钉 Eyebolt Screw | SM25C | |
| 2 | 螺母 Nut | SM35C | 304 |
| 3 | 螺栓 Screw | SM45C | 304 |
| 4 | 阀盖 Bonnet | SCPH2 | SCS13/SCS14 |
| 5 | 密封垫 Gasket | 304+Graphite | PTFE |
| 6 | 支架 Yoke | SCPH2 | SCS13/SCS14 |
| 7 | 螺钉 Screw | SM35C | 304 |

| No. | 零件名称 PAPT NAME | 材质 MATERIAL | |
|-----|---------------------|-------------|-------------|
| 8 | 圆柱销 Cylindrical pin | 304 | 304 |
| 9 | 阀体 Body | SCPH2 | SCS13/SCS14 |
| 10 | 阀瓣 Disc | SCPH2 | SCS13/SCS14 |
| 11 | 摇臂 Rocker | SCPH2 | SCS13/SCS14 |
| 12 | 垫片 Gasket | SS400 | 304 |
| 13 | 螺母 Nut | SM35C | 304 |
| 14 | 螺钉 Screw | SM25C | 304 |

主要外形尺寸和连接尺寸 Main External and Connecting Dimensions

| NPS | D1 | d | K | D | f | C | N-ΦZ | L | H |
|------|-----|-----|-----|-----|---|----|-------|-----|-----|
| 50A | 50 | 96 | 120 | 155 | 2 | 16 | 4-19 | 203 | 158 |
| 65A | 65 | 116 | 140 | 175 | 2 | 18 | 4-19 | 216 | 186 |
| 80A | 80 | 126 | 150 | 185 | 2 | 18 | 8-19 | 241 | 205 |
| 100A | 100 | 151 | 175 | 210 | 2 | 18 | 8-19 | 292 | 235 |
| 125A | 125 | 182 | 210 | 250 | 2 | 20 | 8-23 | 330 | 268 |
| 150A | 150 | 212 | 240 | 280 | 2 | 22 | 8-23 | 356 | 293 |
| 200A | 200 | 262 | 290 | 330 | 2 | 22 | 12-23 | 495 | 359 |
| 250A | 250 | 324 | 355 | 400 | 2 | 24 | 12-25 | 622 | 425 |
| 300A | 300 | 368 | 400 | 445 | 3 | 24 | 16-25 | 698 | 473 |
| 350A | 350 | 413 | 445 | 490 | 3 | 26 | 16-25 | 787 | 499 |
| 400A | 400 | 475 | 510 | 560 | 3 | 28 | 16-27 | 864 | 555 |
| 450A | 450 | 530 | 565 | 620 | 3 | 30 | 20-27 | 978 | 720 |
| 500A | 500 | 585 | 620 | 675 | 3 | 30 | 20-27 | 978 | 810 |

JIS SWING CHECK VALVE 50A-300A H44W-10K

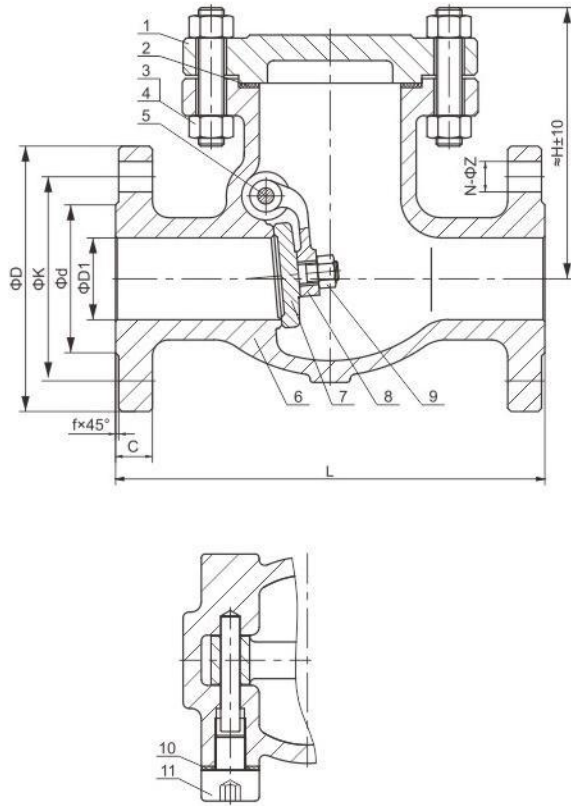

技术要求 Applicable Standards

1. 设计标准 Design Rating: JIS B2071, ASME B 16.34;
2. 结构长度 Face to Face: JIS B2002;
3. 法兰标准 Flanged Ends: JIS B2220;
4. 检查和试验 Inspection & Testing: JIS B2003.

主要零部件材料 Main Parts and Materials

| No. | 零件名称 PAPT NAME | 材质 MATERIAL |
|-----|---------------------|-------------|
| 1 | 阀盖 Bonnet | SCS13/SCS14 |
| 2 | 密封垫 Gasket | PTFE |
| 3 | 螺母 Nut | 304 |
| 4 | 螺柱 Stud | 304 |
| 5 | 圆柱销 Cylindrical pin | 304 |
| 6 | 阀体 Body | SCS13/SCS14 |

| No. | 零件名称 PAPT NAME | 材质 MATERIAL |
|-----|----------------|-------------|
| 7 | 阀瓣 Disc | SCS13/SCS14 |
| 8 | 摇臂 Rocker | SCS13/SCS14 |
| 9 | 螺母 Nut | 304 |
| 10 | 密封垫 Gasket | PTFE |
| 11 | 螺钉 Screw | 304 |
| 12 | | |

主要外形尺寸和连接尺寸 Main External and Connecting Dimensions

| NPS | D1 | d | K | D | f | C | N-ΦZ | L | H |
|------|-----|-----|-----|-----|---|----|-------|-----|-----|
| 50A | 50 | 96 | 120 | 155 | 2 | 16 | 4-19 | 203 | 112 |
| 65A | 65 | 116 | 140 | 175 | 2 | 18 | 4-19 | 216 | 130 |
| 80A | 80 | 126 | 150 | 185 | 2 | 18 | 8-19 | 241 | 147 |
| 100A | 100 | 151 | 175 | 210 | 2 | 18 | 8-19 | 292 | 177 |
| 125A | 125 | 182 | 210 | 250 | 2 | 20 | 8-23 | 330 | 189 |
| 150A | 150 | 212 | 240 | 280 | 2 | 22 | 8-23 | 356 | 209 |
| 200A | 200 | 262 | 290 | 330 | 2 | 22 | 12-23 | 495 | 257 |
| 250A | 250 | 324 | 355 | 400 | 2 | 24 | 12-25 | 622 | 296 |
| 300A | 300 | 368 | 400 | 445 | 3 | 24 | 16-25 | 698 | 343 |